

LEASE ANALYSIS

SUITE A	HOBBY LOBBY	58,770 SF
SUITE B	NEW SCHOOL OF MUSIC	1420 SF
SUITE C	RUBY NAILS	1420 SF
SUITE D	QUEEN OF HEARTS	32,000 SF
SUITE E	LALANNE'S HAIR SALON	1400 SF
SUITE F	HERTZ	1400 SF
SUITE J	NORTHERN TOOL	15,486 SF
SUITE K	DENTISTRY FOR CHILDREN	2415 SF
SUITE L	AVAILABLE	2415 SF
SUITE M	H&R BLOCK	1400 SF
SUITE N	AVAILABLE	1400 SF
SUITE O	CRYSTAL CLEAR	2765 SF
SUITE P	AVAILABLE	4165 SF
SUITE S	MARCHELLO'S ITALIAN	2800 SF
SUITE T	AVAILABLE	1400 SF
SUITE T-1	AVAILABLE	1400 SF
SUITE U	PANDA BATH-AVAILABLE	2800 SF
SUITE V	BODYPLEX FAMILY	30,942 SF
TOTAL SHOPPING CENTER AREA		165,798 SF
OUTPARCEL F (ZAXBY'S)		±3,307 SF
OUTPARCEL G (WAFFLE HOUSE)		±1,620 SF
TOTAL AREA		±170,725 SF
PARKING		967 SPACES
PARKING RATIO		5.6 SP/1000 SF
TOTAL SITE AREA		19.649 ACRES

BUILDING AREAS HAVE NOT BEEN CALCULATED BY HILL FOLEY ROSSI, LLC

INTERIOR IMPROVEMENTS (PARKING SPACES, ISLANDS, BUILDING FRONT, ETC.) HAVE NOT BEEN FIELD LOCATED AND ARE SHOWN FOR REFERENCE ONLY. INFORMATION SHOWN HAS BEEN BASED ON AN ELECTRONIC FILE FROM ROCHESTER AND ASSOCIATES. INFORMATION SHOWN IS APPROXIMATE IN NATURE.

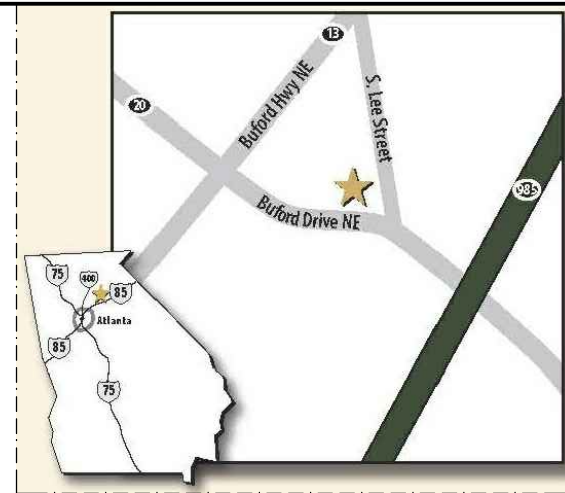

4125 BUFORD DRIVE (HWY. 20)
BUFORD GA 30518

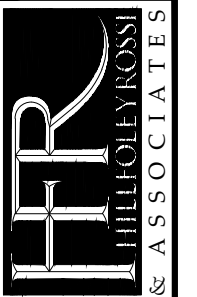
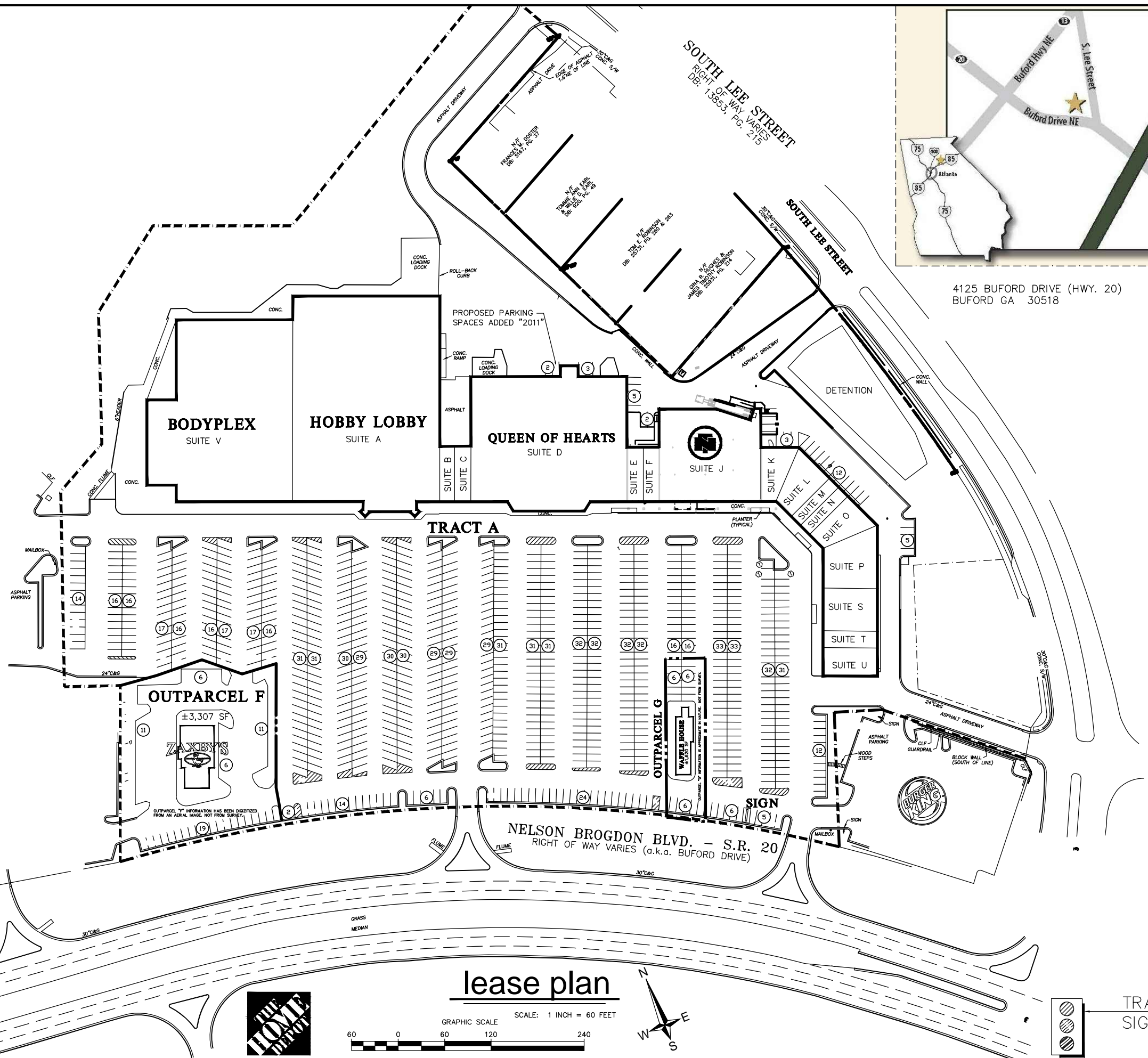

**ARCHITECTURE
ENGINEERING**
3680 Pleasant Hill Road
Suite 200
Duluth, Georgia 30096
p 770.622.9858
f 770.622.9535
www.hillfoleyrossi.com

© Copyright (as dated below). This drawing and all information contained on the property of Hill Foley Rossi & Associates, LLC (HFR) is intended for the sole use of the project named herein. Reproductions without the written consent of HFR is prohibited. All copies are to be returned to HFR upon project completion.

sealed:

Northern Tool + Equipment
Lee's Crossing Retail Center
City of Buford, Hall County GA

Retail Planning Corporation
35 Johnson Ferry Road
Marietta, GA 30068

1	10.21.11	OWNER REVIEW
mk	date	issue

lease plan

L.1
HFR 11.144

lease plan

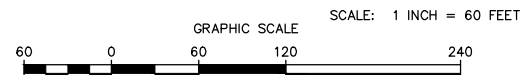

TRAFFIC SIGNAL

SUZUKI MALL OF GA.

DETENTION TRACT

