

LEASE ANALYSIS		
SUITE 1	STARBUCKS	1573 SF
SUITE 2	AVAILABLE	1626 SF
SUITE 3	DENTIST	2192 SF
SUITE 5	VENUS NAILS	1275 SF
SUITE 6	AUDIOLOGICAL CONSULTANT	1275 SF
SUITE 6A	MARCO'S PIZZA	1739 SF
SUITE 7	SIGNATURE DRY CLEANERS	2347 SF
TOTAL AREA		12,027 sf
PARKING		60 SPACES
PARKING RATIO		5 SP/1000 SF
TRACT 1 AREA		1.665 ACRES

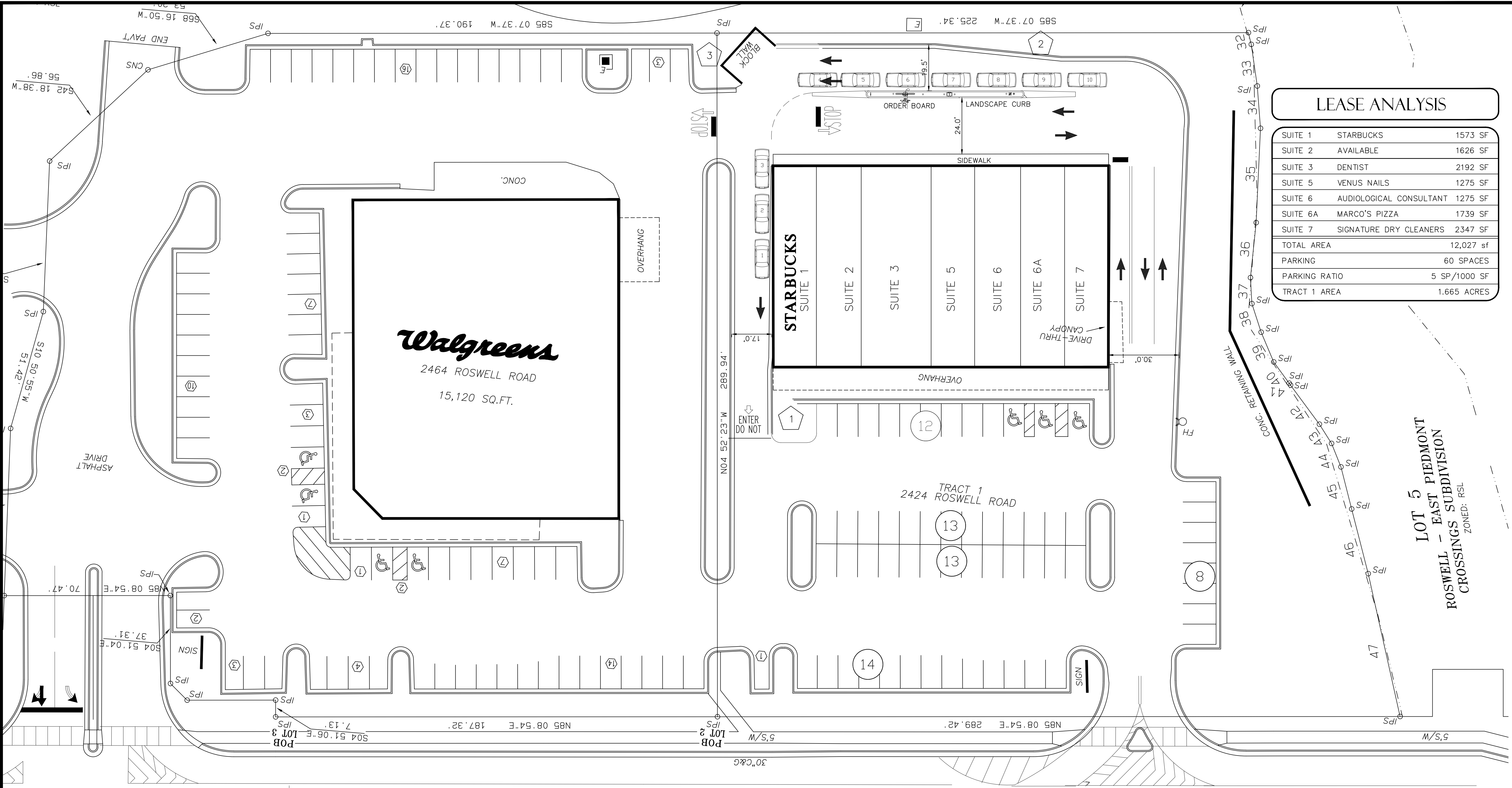

**S.R. 120 - ROSWELL ROAD (R/W VARIES)**

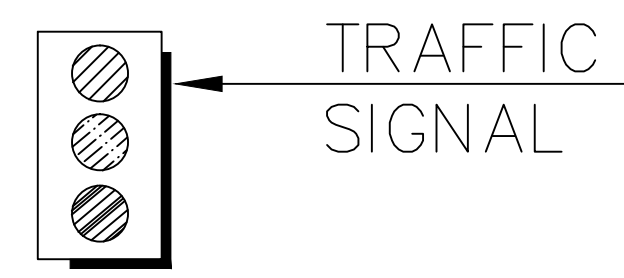

- 1 PROPOSED PATIO. LOSE ONE SPACE. RELOCATE H.C.
- 2 REMOVE 5 PARKING SPACES. NEW CURB & GUTTER.
- 3 EX. DUMPSTER. ACCESS DOOR. ADD

**preliminary site plan**

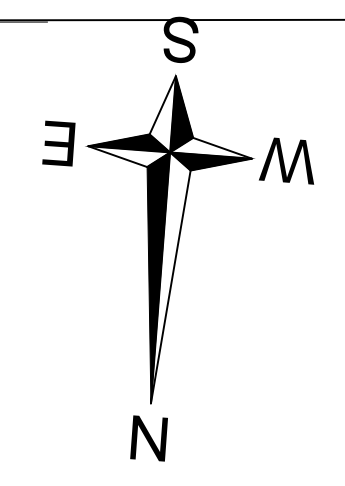
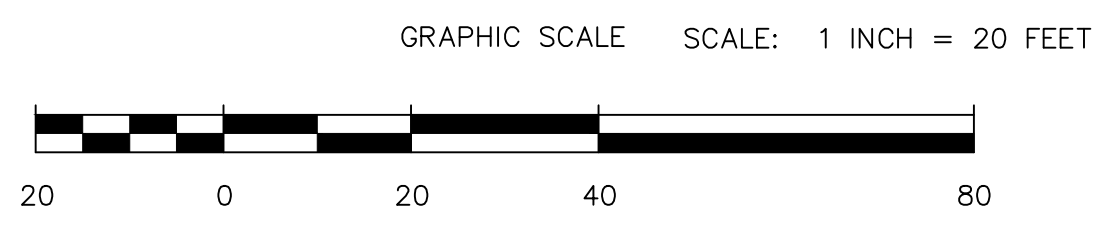

INFORMATION SHOWN HAS BEEN BASED ON AN ELECTRONIC AS-BUILT SURVEY BY ROCHESTER AND ASSOCIATES DATED 12-18-2002.